

1 **Title:** Traditional surveys versus ecological momentary assessments: digital citizen science  
2 approaches to improve ethical physical activity surveillance among youth

3 **Authors:** Sheriff Tolulope Ibrahim<sup>1</sup>, Nour Hammami<sup>2</sup>, Tarun Reddy Katapally<sup>1,3,4</sup>

4 **Affiliations:**

5

6 <sup>1</sup> DEPtH Lab, School of Health Studies, Faculty of Health Sciences, Western  
7 University, London, Ontario, N6A 3K7, Canada; [tarun.katapally@uwo.ca](mailto:tarun.katapally@uwo.ca)  
8 (T.R.K.).

9

10 <sup>2</sup> Trent University Durham, 55 Thornton Road South, Oshawa, Ontario, L1J 5Y1,  
11 Canada; [nourhammami@trentu.ca](mailto:nourhammami@trentu.ca) (N.H.).

12

13 <sup>3</sup> Department of Epidemiology and Biostatistics, Schulich School of Medicine and Dentistry,  
14 Western University, London, Ontario, N6A 3K7, Canada; [tarun.katapally@uwo.ca](mailto:tarun.katapally@uwo.ca).

15

16 <sup>4</sup> Children's Health Research Institute, Lawson Health Research Institute, 750 Base Line  
17 Road East, Suite 300, London, Ontario, Canada N6C 2R5

18

19

20 **Corresponding author:**

21 Tarun Reddy Katapally  
22 School of Health Studies  
23 Faculty of Health Sciences  
24 Western University  
25 1151 Richmond St  
26 London, ON N6A 3K7.

27 Phone: +1(519) 661-4249

28 Email: [tarun.katapally@uwo.ca](mailto:tarun.katapally@uwo.ca)

29

30 *Keywords: Digital Health; Citizen Science; Physical Activity; Ecological Momentary*  
31 *Assessments; Ethical Surveillance*

32

33

34

35

36

37

38

39

40

41

42

43

44

45

46

47

48

49

50

51

52

53

**NOTE:** This preprint reports new research that has not been certified by peer review and should not be used to guide clinical practice.

44  
45  
46  
47  
48  
49  
50  
51  
52  
53  
54  
55  
56  
57  
58  
59  
60  
61  
62  
63  
64  
65  
66  
67  
68  
69

## Abstract

### Background

The role of physical activity (PA) in minimizing non-communicable diseases is well established. Measurement bias can be reduced via ecological momentary assessments (EMAs) deployed via citizen-owned smartphones. This study aims to engage citizen scientists to understand how PA reported digitally by retrospective and prospective measures varies within the same cohort.

### Methods

This study used the digital citizen science approach to collaborate with citizen scientists, aged 13-21 years over eight consecutive days via a custom-built app. Citizen scientists were recruited through schools in Regina, Saskatchewan, Canada in 2018 (August 31 - December 31). Retrospective PA was assessed through a survey, which was adapted from three validated PA surveys to suit smartphone-based data collection, and prospective PA was assessed through time-triggered EMAs deployed consecutively every day, from day 1 to day 8, including weekdays and weekends. Data analyses included t-test to understand the difference in PA reported retrospectively and prospectively, and linear regressions to assess contextual and demographic factors associated with PA reported retrospectively and prospectively.

### Result

Findings showed a significant difference between PA reported retrospectively and prospectively ( $p = 0.001$ ). Ethnicity (visible minorities:  $\beta = -0.911$ , 95% C.I.= -1.677, -0.146), parental education (university:  $\beta = 0.978$ , 95% C.I.= 0.308, 1.649), and strength training (at least one day:  $\beta = 0.932$ , 95% C.I.= 0.108, 1.755) were associated with PA reported prospectively. In contrast, the number of active friends (at least one friend:  $\beta = 0.741$ , 95% C.I.= 0.026, 1.458) was associated with retrospective PA.

70 **Conclusion**

71 Physical inactivity is the fourth leading cause of mortality globally, which requires accurate  
72 monitoring to inform population health interventions. In this digital age, where ubiquitous  
73 devices provide real-time engagement capabilities, digital citizen science can transform how  
74 we measure behaviours using citizen-owned ubiquitous digital tools to support prevention and  
75 treatment of non-communicable diseases.

76

77

78

79

80

81

82

83

84

85

86

87

88

89

90

91

92

93

94

95

96

97

98

99 **Author summary**

100 Traditionally, the surveillance of physical activity has been predominantly conducted with  
101 retrospective surveys that require participants to recall behaviours, a methodology which has  
102 significant challenges due to measurement bias. With advances in digital technology,  
103 ubiquitous devices offer a solution through ecological momentary assessments (EMAs). Using  
104 the Smart Framework, which combines citizen science with community-based participatory  
105 research, this study ethically obtained retrospective and prospective EMA physical activity data  
106 from the same cohort of youth citizen scientists, who used their own smartphones to engage  
107 with our team over an eight-day period. The findings show a significant difference between  
108 physical activity reported through retrospective and prospective EMAs. Moreover, there was  
109 also a variation between contextual and demographic factors that were associated with  
110 retrospective and prospective physical activity – evidence that points towards the need to adapt  
111 physical activity surveillance in the digital age by ethically engaging with citizens via their own  
112 ubiquitous digital devices.

113

114

115

116

117

118

119

120

121

122

123

124

## 125 **Background**

126 Physical activity is an important protective factor that can prevent or minimize non-  
127 communicable diseases such as diabetes mellitus, cancer, obesity, hypertension, and joint  
128 conditions [1–4]. However, measuring physical activity (PA) can be plagued with challenges  
129 and inaccuracies, such as over-reporting of PA [5], recall bias [6], lack of environmental and  
130 social context of PA, and difficulty in reporting PA in the form of intensities (e.g., moderate,  
131 and vigorous activities) [7–9]. The continued understanding of how PA is accumulated, and its  
132 accurate measurement, is crucial in identifying patterns of PA, and to accurately monitor  
133 population adherence to PA recommendations [10,11].

134 Traditionally, retrospective means of measurement have been used to measure PA accumulation  
135 [12,13]. Retrospective surveys in general are easy to implement and are not resource intensive  
136 [14], however they tend to overestimate PA [15,16], which can be attributed to recall biases  
137 [8,17]. For instance, in a study carried out on lower back pain patients and healthy controls, it  
138 was determined that retrospective surveys overestimated self-reported moderate physical  
139 activity by 42min/day, and vigorous activity by 39min/day [18]. Objective measures of PA,  
140 such as the use of accelerometers, global positioning system, heart rate monitoring, and  
141 movement sensors, can solve the problem of recall bias present in retrospective subjective  
142 questionnaires. However, objective measures can be time consuming [19], expensive [20], and  
143 logistically challenging to implement across populations [21–23].

144 Advances in information and communication technology offer novel opportunities in PA  
145 measurement [24,25]. Ubiquitous tools such as smartphones can enable ecological momentary  
146 assessments (EMAs) to be deployed via smartphones in near real-time, and with more  
147 frequency by using time-, location-, and user-triggers, which provide flexibility for both  
148 researchers and study participants [26,27]. EMAs assess participants' experience/behaviour in  
149 real-time, and in the real-world, where researchers use sampling and monitoring strategies to

150 assess phenomena as they occur in natural settings [17]. More recently, the use of EMAs in  
151 assessing PA behaviour using citizen-owned smartphones has gained momentum among  
152 researchers [26–28], due to its ability to eliminate recall [23], and social desirability biases [29]  
153 that are inherent in retrospective subjective PA surveys [30,31].

154 This study aims to ascertain if there is a significant difference between the duration of PA  
155 reported retrospectively using traditional validated surveys, and duration of PA reported  
156 prospectively using EMAs, within the same cohort of participants. In addition, this study  
157 assesses contextual and demographic factors that are associated with duration of PA reported  
158 retrospectively vs. prospectively (EMAs) within the same cohort of participants.

## 159 **Methodology**

160 This study captures PA behaviours, and its related factors from youth who participated in the  
161 Smart Platform as youth citizen scientists [26]. The Smart Platform is a citizen science and  
162 digital epidemiological initiative for population health surveillance, knowledge translation, and  
163 real-time interventions [32,33]. It combines participatory, community-based, and citizen  
164 science approaches to leverage citizen-owned smartphones to ethically engage citizen scientists  
165 for population health research. The research ethics approval for the Smart Platform was  
166 approved by the Research Ethics Boards of the Universities of Regina and Saskatchewan (REB  
167 # 2017-029).

168 The Smart Platform enabled our research team to use a custom-built smartphone application  
169 (app) to engage with citizen scientists [26,27] over eight consecutive days [34] Youth citizen  
170 scientists had the option to download the app from both the iOS and Android platforms onto  
171 their smartphones. Using the app, apart from PA data, a wide range of behavioural, contextual,  
172 demographic, social factors were reported by youth [26,27,33]. This study used the following  
173 data that were derived using surveys deployed via the app [25,26]: family and peer support for

174 PA; sociodemographic characteristics; and individual characteristics that determined overall  
175 PA, such as strength training.

## 176 **Participants**

177 A total of 808 youth citizen scientists (13 – 21 years) were recruited for this study. Youth citizen  
178 scientists were recruited through Regina Public and Catholic Schools engagement sessions held  
179 in various high schools in Regina, Saskatchewan, Canada in 2018. Citizen scientists were  
180 recruited through a collaborative effort between the school administrators and the research  
181 team. Scheduled in-person recruitment sessions were organized between the research team and  
182 the youth. Activities during the recruitment sessions included describing the study to youth,  
183 demonstration of how to use the app, answering queries and concerns, and assisting youth in  
184 downloading the app onto their respective smartphones. All youth participants of the study  
185 provided informed consent through the app. For youth participants between the ages of 13-16  
186 years, implied informed consent was obtained from their caregivers and parents before the  
187 scheduled recruitment sessions.

## 188 **Measures**

### 189 **PA (dependent variables)**

190 On day one of the study, using a time-triggered smartphone nudge, retrospective PA data (over  
191 previous 7 days) were collected from youth through a modified survey adapted from three  
192 validated self-reported measures [35–39]. The modification allowed time-triggered digital  
193 deployment of the retrospective survey and accommodated the varying start dates of youth  
194 joining the study (**Figure 1**). Youth could download and join the study between (August 31 -  
195 December 31). Irrespective of the time when youth joined the study, a time-triggered  
196 retrospective survey was deployed that ensured the exact dates of the previous 7 days were  
197 reflected in the app to improve recall (**Figure 1**).

198 After defining PA, the retrospective survey provided youth the opportunity to report PA they  
199 accumulated over the previous seven days starting from the day of joining the study. From these  
200 responses, mean overall PA per day (will be referred to as: retrospective PA duration) was  
201 derived. Following general PA data derivation standards [40,41], youth who reported less than  
202 10 minutes or more than 960 minutes (about 16 hours) per day were excluded from the analyses  
203 [41,42].



204

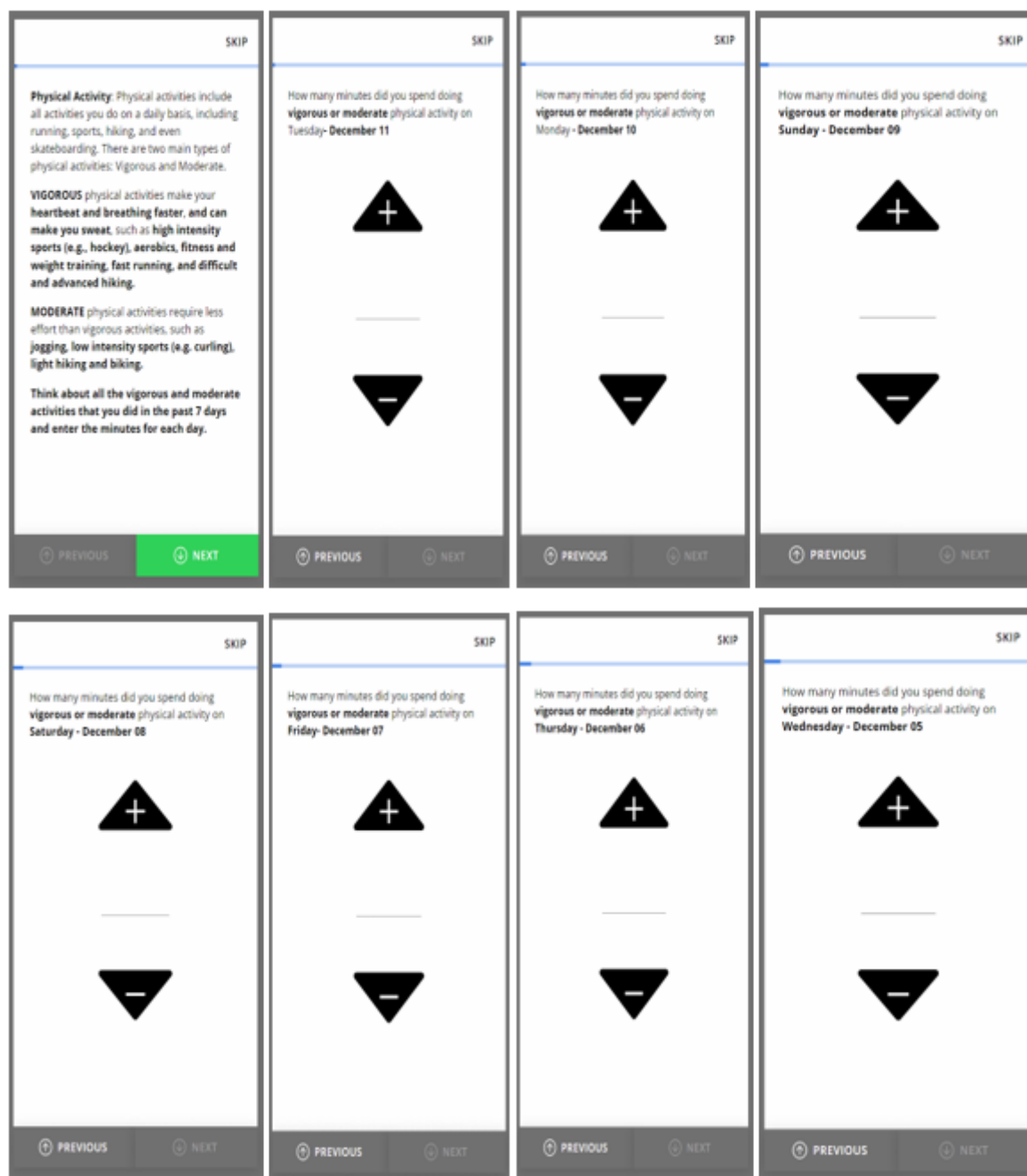

205

206 Figure 1: Digitally deployed modified retrospective PA survey.

207 Prospective PA information was obtained via daily time-triggered EMAs throughout the study  
208 period (eight consecutive days), to include both weekdays and weekends. The EMAs were  
209 deployed every evening between 8:00 PM to 11:30 PM and were set to expire at midnight [26].  
210 EMAs used skip-pattern questions to capture PA accumulation (Figure 2). After defining what

211 constitutes PA, EMAs asked youth the following questions: 1) “What type of physical activities  
212 did you do today?” (Multiple choice); 2) “How many minutes did you spend doing this  
213 activity?” (Open ended). From these questions, mean PA per day was derived (will be referred  
214 to as: EMA PA duration).

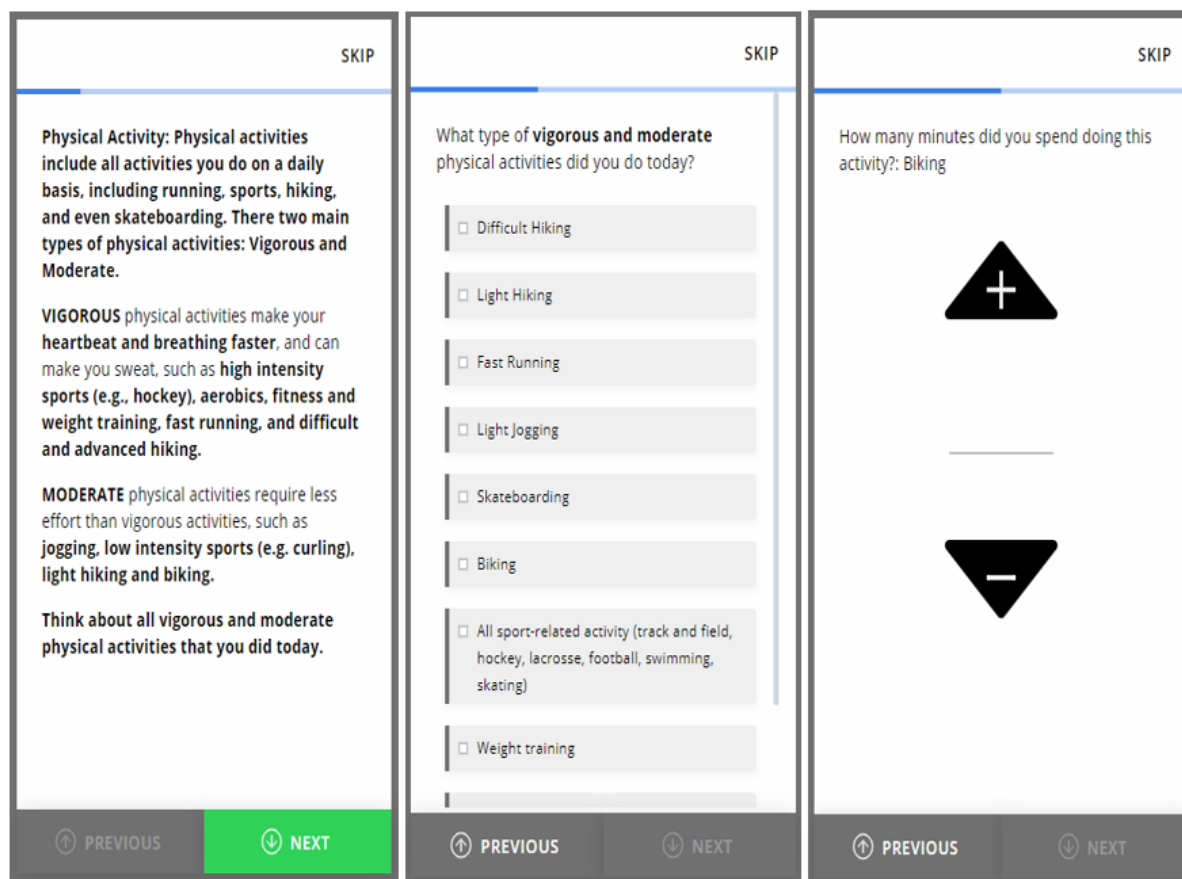

215  
216 **Figure 2:** EMAs PA types, and duration.

217  
218

### 219 **Family support for PA (independent variables)**

220 Family support PA was captured using one question: “How much do your parents, stepparents,  
221 or guardians support you in being physically active? (e.g., driving you to team games, buying  
222 you sporting equipment)” with the 4 response options: “very supportive”, “supportive”,  
223 “unsupportive”, or “very unsupportive”. Using these data, we collapsed the responses into:

224 “unsupportive” (combining unsupportive and very unsupportive), “supportive” and “very  
225 supportive”.

### 226 **Peer support for PA (independent variables)**

227 Youth were asked to think about their closest friends in the last 12 months when answering the  
228 question regarding peer support of PA. Peer support for PA was captured with the question:  
229 “How many of your closest friends are physically active?” with the six response options: “none  
230 of my friends”, “1”, “2”, “3”, “4”, or “5 of my friends”. This variable was dichotomized into  
231 “0 physically active friends” corresponding to “none of my friends” and “at least 1 active  
232 friend” corresponding to “1”, “2”, “3”, “4” or “5 of my friends”.

### 233 **Sociodemographic covariates**

234 Gender was ascertained with the question, “What is your gender?”, with 5 response options:  
235 “male”, “female”, “transgender”, “other (please specify)”, and “prefer not to disclose”. The  
236 responses “transgender”, “other”, and “prefer not to disclose” were collapsed into one category  
237 due to low counts within these categories. Parental education was measured by asking youth to  
238 report the “highest education” of one of their parents or guardians, with six response options:  
239 “elementary school”, “some secondary/high school”, “completed high school”, “some post-  
240 secondary (university/college)”, “received university or college degree /diploma”, and “does  
241 not apply”. From these responses, four categories of parental education were derived: 1)  
242 “elementary school” corresponds to “elementary school or below”, 2) “some secondary/high  
243 school” and “completed high school” corresponds to “at least secondary school” 3) “some post-  
244 secondary (university /college)”, “received university or college degree/diploma” corresponds  
245 to “university and above” and “does not apply”.

246 Youth citizen scientists were also asked about their ethnicity, with the following response  
247 options: “First Nations”, “Dene”, “Cree”, “Metis”, “Inuit”, “African”, “Asian”, “Canadian”,  
248 “Caribbean/West Indian”, “Eastern European”, “European”, “South Asian”, “other”, and

249 “Mixed”. From these responses, four categories were extracted: 1) “Indigenous” which  
250 corresponds to “First Nations”, “Dene”, “Cree”, “Metis”, “Inuit”, 2) “Canadian”, 3) “mixed”  
251 and 4) “visible minorities”. The visible minorities include “African”, “Asian”, “Caribbean/West  
252 Indian”, “Eastern European”, “European”, “South Asian”, and “other” categories. The visible  
253 minorities category was created due to low count within these ethnic categories.

#### 254 **Strength training (independent variables)**

255 Strength training was captured using the following questions “On how many days in the last 7  
256 days did you do exercises to strengthen or tone your muscles? (e.g., push-ups, sit-ups, or weight-  
257 training)” with the eight response options including “0”, “1”, “2”, “3”, “4”, “5”, “6”, or “7  
258 days”. We dichotomized these responses into “0 days of strength training” corresponding to 0  
259 days and “at least 1 day of strength training” corresponding to “0”, “1”, “2”, “3”, “4”, “5”, “6”,  
260 or “7 days”.

#### 261 **Data and risk management**

262 To ensure confidentiality, all data were encrypted before being streamed to a secure cloud  
263 server. Identifiable artifacts (e.g., photos, voice recordings) were removed or de-identified  
264 before the data were analyzed. A permission built into the app restricted access to personally  
265 identifiable information (e.g., contact list or network visited). Media Access Control address  
266 anonymization was used to protect youth citizen scientists’ data based on a simple hash  
267 algorithm. Risks and privacy management options were made clear to youth citizen scientists  
268 while obtaining informed consent. In addition, citizen scientists not only had the option to drop  
269 out of the study or pause data gathering anytime they wished, but also had the option to upload  
270 data only when they had Wi-Fi access and /or when their smartphones were plugged into a  
271 power source. Together with the above features, youth citizen scientists also had the option to  
272 drop out of the study at any point of time [27] (**Figure 3**).

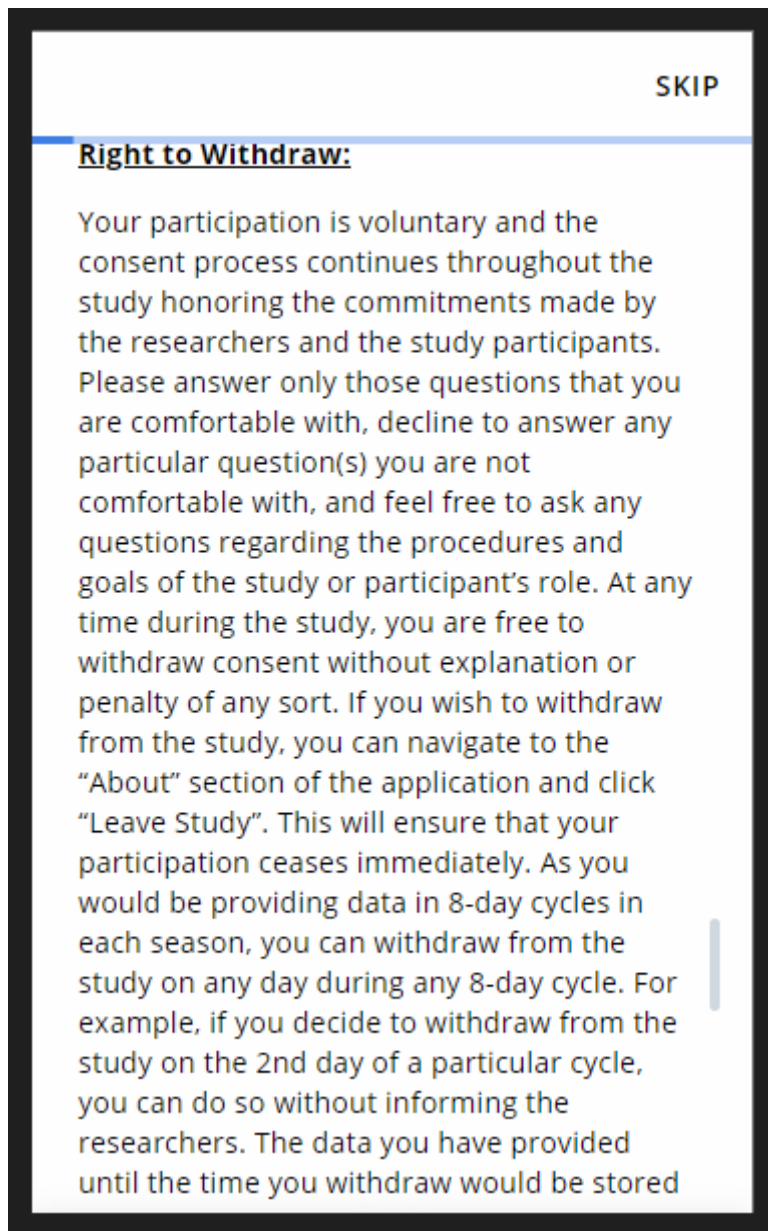

273

274 **Figure 3:** Study withdrawal information feature

275

276 **Data Analysis**

277 Descriptive statistics, such as frequencies and percentages were used in describing the

278 independent variables of this study. T-test inferential statistics was used to ascertain difference

279 between mean minutes of PA reported via retrospective PA survey and mean minutes of PA

280 reported via EMAs. Multiple linear regression models were used to assess factors associated

281 with mean minutes of PA reported retrospectively and prospectively (EMAs), while adjusting  
282 for control variables. Data analyses were conducted using R 4.2.1 statistical tool. A significance  
283 level was set at  $p < 0.05$ .

## 284 **Results**

285 A total of 808 youth citizen scientists (13 – 21 years) were recruited for this study. After  
286 excluding participants who did not report on primary dependent and independent variables, the  
287 final sample size of this study was 436.

288 Table 1 presents the summary statistics of youth citizen scientists. Youth were predominantly  
289 females (55.8%), with 38.5% being males and 5.7% reporting one of following categories:  
290 transgender, other, or preferred not to disclose. Majority of youth identified themselves as  
291 Canadian (39.8%), followed by mixed (29.7%), visible minority (25.5%), and Indigenous  
292 (5%). In terms of socioeconomic status, most youth (65.1%) reported that one of their parents  
293 had a university degree. In terms of strength training, 76.5% of youth reported having at least  
294 one day of strength training, while 23.5% reported having zero days of strength training.

295 In terms of social context/support for PA, 88.7% reported having at least one or more physically  
296 active friends, while 45.3% reported that parents/guardians are supportive of their PA, and  
297 42.9% reported that parents/guardians are very supportive of their PA.

298

299

300 **Table 1:** Summary statistics for youth citizen scientists participating in this study (n=436).

	<b>Percentage</b>
<b>Gender</b>	
Male (n=161)	38.5
Female (n=233)	55.8
Transgender / Other / Prefer not to disclose (n=24)	5.7

Total (n=418) <sup>a</sup>	100
<b>Ethnicity</b>	
Indigenous (n=21)	5.0
Canadian (n=166)	39.8
Mixed (n= 124)	29.7
Visible minority (n=106)	25.5
Total (n=417) <sup>a</sup>	100
<b>School</b>	
1 (n=110)	25.3
2 (n=74)	17.1
3 (n=50)	11.5
4 (n=78)	18.0
5 (n=122)	28.1
Total (n=434) <sup>a</sup>	100
<b>Grade</b>	
Grade 9 (n=125)	29.7
Grade 10 (n=86)	20.4
Grade 11 (n=61)	14.5
Grade 12 (n=149)	35.4
Total (n=421) <sup>a</sup>	100
<b>Parental education</b>	
Elementary or below (n= 12)	2.8
At least secondary school (n=91)	21.0
University and above (n =282)	65.1
Does not apply (n=48)	11.1
Total (n=433) <sup>a</sup>	100
<b>Strength training</b>	
zero days of strength training (n=97)	23.5
At least one day of strength training (n=315)	76.5
Total (n=412) <sup>a</sup>	100
<b>Family support for PA</b>	
Unsupportive (n=49)	11.8
Supportive (n=188)	45.3
Very supportive (n=178)	42.9
Total (n=415) <sup>a</sup>	100
<b>Peer Support for PA</b>	
zero active friends (n= 47)	11.3
At least one active friend (n=368)	88.7

Total (n=415) <sup>a</sup>	100
<sup>a</sup> Some youth did not provide response to this question	

301

302 The summary statistics of the dependent variables: retrospective PA and prospective PA EMAs  
 303 were presented in Table 2. The mean time spent on PA per day (in minutes) reported via the  
 304 retrospective PA survey and prospective EMAs were 93 and 196, respectively. The t-test result  
 305 of 3.237 ( $p = 0.001$ ) suggests a statistically significant difference between mean duration of PA  
 306 reported by youth retrospectively and prospectively (EMAs).

307

308 **Table 2:** Mean time spent on PA per day (in minutes) as reported in the retrospective survey  
 309 and the prospective EMAs and t-test analysis.

	Mean (Minutes per day)	Minimum (minutes)	Maximum (minutes)	t-test (p- value)
Retrospective PA (Measured via retrospective survey)	93	13.0	557.0	3.237 (0.001)
Prospective PA (Measured via EMA)	196	10.0	910.0	

310

311 The adjusted, linear regression models showing the relationship between (EMA PA [model 1]  
 312 and Retrospective PA [model 2]), and contextual and demographic factors are presented in  
 313 Table 3.

314

315 **Table 3:** Factors associated with PA duration measured via prospective (EMA; results of Model  
 316 1) and retrospective PA survey measures (Retrospective PA; results of Model 2).

	<b>Model 1: EMA PA duration</b>		<b>Model 2: Retrospective PA duration</b>	
	<b>Beta coefficients<sup>a</sup> (95% CI)</b>	<b>P-value</b>	<b>Beta coefficients<sup>a</sup> (95% CI)</b>	<b>P-value</b>



<b>Ethnicity -Canadian (Ref.)</b>				
Indigenous	-3.336 (-6.816, 0.143)	0.066	0.163 (-2.726, 3.052)	0.912
Mixed	0.287 (-0.350, 0.925)	0.381	0.205 (-0.324, 0.734)	0.451
Visible minority	-0.911*** (-1.677, -0.146)	0.024	0.106 (-0.530, 0.742)	0.745
<b>Parental education<sup>b</sup> – At least secondary school (Ref.)</b>				
University and above	0.978*** (0.308, 1.649)	0.006	0.262 (-0.294, 0.819)	0.360
Does not apply	0.768 (-0.341, 1.878)		-0.016 (-0.937, -0.905)	0.973
<b>Strength training</b>				
<b>zero days of strength training (Ref.)</b>				
At least one day of strength training	0.932*** (0.108, 1.755)	0.031	0.357 (-0.326, 1.041)	0.310
<b>Family support for PA</b>				
<b>Unsupportive (Ref.)</b>				
Supportive	-0.593 (-1.479, -0.293)	0.195	-0.702 (-1.438, 0.033)	0.067
Very supportive	-0.412 (-1.253, 0.429)	0.342	-0.026 (-0.724, 0.673)	0.942
<b>Peer support for PA</b>				
<b>zero physically active friends (Ref.)</b>				
At least one active friend	0.169 (-1.693, 1.032)	0.702	0.741*** (0.026, 1.458)	0.048

<b>Constant</b>	4.215 (-1.496, 9.927)	0.154	1.339 (-3.402, 6.081)	0.582
<p>*** <math>p &lt; 0.05</math>. All regression models controlled for: Gender, School, and Age  <sup>a</sup> Log dependent variable requires the transformation <math>100 * (2.7182^\beta - 1)</math> [43] to interpret parameter estimate.  <sup>b</sup> Elementary school category dropped by software due to incomplete information in dependent variables</p>				

317  
318 In the EMA model (i.e., prospective PA: model 1), youth whose ethnicity was categorized as  
319 visible minorities reported less PA ( $\beta = -0.911$ , 95% confidence interval [C.I.] = -1.677, -0.146,  
320 p-value = 0.024) in comparison with youth whose ethnicity was Canadian. This association  
321 was not found to be statistically significant in the retrospective PA model (i.e., retrospective  
322 PA: model 2). Similarly, youth who reported at least one parent having a university degree  
323 accumulated more EMA PA ( $\beta = 0.978$ , 95% [C.I.] = 0.308, 1.649, p-value = 0.006) in  
324 comparison with youth who reported that their parents had at least secondary school education.  
325 This association was not found to be statistically significant in the retrospective PA model.  
326 Following the same pattern, youth who engaged in at least one day of strength training reported  
327 more PA via EMAs ( $\beta = 0.932$ , 95% [C.I.] = 0.108, 1.755, p-value = 0.031) in comparison with  
328 youth who reported zero days of strength training. This association was not found to be  
329 statistically significant in the retrospective PA model.

330 In the retrospective PA model, youth who reported having at least one friend who is physically  
331 active were significantly associated with more PA ( $\beta = 0.741$ , 95% [C.I.] = 0.026, 1.458, p-  
332 value = 0.048) in comparison to youth who reported having zero physically active friends. This  
333 association was not found to be statistically significant in the EMA model.

### 334 **Discussion**

335 This study was conducted by engaging youth citizen scientists using their own smartphones by  
336 utilizing a methodology that integrates ethical population health surveillance, integrated  
337 knowledge translation, and real-time behavioural interventions [32]. The primary purpose of

338 this study was to ascertain if there was a significant difference between the duration of PA  
339 reported retrospectively using a modified version of three validated PA questionnaires and  
340 duration of PA reported prospectively using EMAs within the same cohort of youth aged 13-  
341 21 years. In addition, the study also assessed sociodemographic and contextual factors that are  
342 associated with duration of PA reported retrospectively vs. prospectively.

343 The primary finding was that there was a significant difference in PA reported retrospectively  
344 using the modified retrospective PA survey in comparison with PA reported prospectively using  
345 EMAs, with youth reporting more PA using prospective EMAs. In a similar study, although  
346 carried out on a cohort of adult participants [26], more PA was reported using a validated  
347 retrospective survey in comparison to EMAs. This discrepancy between adult and youth  
348 reporting of duration of PA needs further exploration. Evidence indicates that there are  
349 differences in how adults and youth accumulate PA [44], with youth engaging more in frequent  
350 habitual activities [45], resulting in intermittent PA [45], that could be better suited to capture  
351 via prospective EMAs. There is also some evidence that overestimation of PA using self-  
352 reported retrospective measures is more likely to occur in older adults [36]. More importantly,  
353 as this study was implemented via ubiquitous digital tools (i.e., smartphones), it is important to  
354 consider the level of digital literacy of youth, which is known to be higher than adults [46,47],  
355 could have played a role in youth having proficiency in reporting PA using digital EMAs.

356 According to the United Nations Educational, Scientific and Cultural Organization, “digital  
357 literacy is the ability to access, manage, understand, integrate, communicate, evaluate, and  
358 create information safely and appropriately through digital devices and networked technologies  
359 for participation in economic and social life. It includes competences that are variously referred  
360 to as computer literacy, ICT literacy, information literacy, and media literacy” [48]. In  
361 employing EMAs in prospective capture of duration of PA, it is important to consider the digital  
362 literacy of the participants to ensure that the methods of EMA deployment align with the level

363 of digital literacy. In our study, we used citizen science approaches to engage with youth before  
364 EMA deployment to ensure that they can report PA with ease [26]. This engagement included  
365 relationship building with the schools and organizing presentation sessions, where youth had  
366 the opportunity to ask questions and even suggest potential changes to EMA deployment. For  
367 instance, although before deployment EMAs were set up to expire within an hour, after  
368 feedback from youth citizen scientists during the engagement sessions, we increased the time  
369 of expiry to maximize daily PA reporting opportunities [27]

370 As for the sociodemographic and contextual factors associated with duration of PA, this study  
371 indicates that there are several differences in associations between duration of PA reported  
372 retrospectively vs. prospectively. The retrospective PA model (Table 3: Model 2) depicted one  
373 significant association, where youth who reported having at least one physically active friend  
374 also reported more minutes of PA. This finding is consistent with previous quantitative and  
375 qualitative PA studies [49–51], where peer support was found to increase PA of youth. The  
376 EMA model (Table 3: Model 1) depicted three significant associations. Youth who reported at  
377 least one parent having a university degree in comparison with youth whose parents have high  
378 school or lower education, and youth who engaged in at least one day of strength training in  
379 comparison to youth who reported zero days of strength training reported more minutes of PA.  
380 Although not many studies have been carried out to ascertain factors that are associated with  
381 PA duration reported using EMAs by youth, these findings are consistent with existing evidence  
382 [52–55]. Finally, the EMA model also showed that visible minority youth reported lower  
383 duration of PA in comparison with youth who identified themselves as Canadian, a finding that  
384 is consistent with previous studies that have examined differences of PA among ethnicities  
385 [56,57].

386 More importantly, although our findings are consistent with existing evidence, the key finding  
387 here is the difference in sociodemographic and contextual factors that were associated with

388 duration of PA reported retrospectively vs. prospectively. If we are to develop appropriate  
389 interventions to address global physical inactivity [58–60], it is critical to accurately understand  
390 the factors that determine PA accumulation. A clear difference between factors that are  
391 associated with PA reported retrospectively vs. prospectively by the same cohort of individuals  
392 shows that further investigation is needed to understand physical activity measurement,  
393 particularly in the digital age, where ubiquitous tools are available to obtain data in real-time  
394 [26,27,61].

395 There is considerable evidence that prospective EMAs are effective measures in estimating  
396 determinants and correlates of PA in real-time and real-world settings and their validity and  
397 reliability in measuring PA has been established [62,63]. EMAs reduce participant burden by  
398 using digital reminders/nudges that can be triggered on participants' smartphones based on time,  
399 and location. EMAs can also be self-triggered by participants, which provides them the capacity  
400 to provide information that is tailored to their needs and circumstances [64,65]. EMAs are also  
401 known to reduce recall bias since participants do not need to recall their behaviours [17], a  
402 significant factor in improving PA measurement in real-world settings.

403 It is important to note that EMAs can transform how data are collected in the digital age,  
404 because they can be completed at participants' convenience, and in collaboration between the  
405 researchers and the participants i.e., digital citizen science [26,66]. It is also important to  
406 consider the age cohort involved in data collection i.e., EMAs are more appealing to young  
407 participants with greater digital literacy [46,63].

408 Evidence also indicates that EMAs provide ecological validity of whether associations are  
409 significant in relation to typical settings of everyday life [67,68]. PA measurement using EMAs  
410 provide context, improves data validity through reduction of recall bias and data entry errors as  
411 participants are not required to retrospectively recall their behaviours [69,70]. EMAs reduce  
412 participant burden by using digital reminders/ nudges that can be triggered on participants'

413 phones based on predefined time and location [69,71]. In addition, EMAs can also be self-  
414 triggered by participants, which allows them some level of personalization to their needs  
415 [69,72]. One clear indication is that in the digital age, where smartphone usage is almost  
416 universal [73,74], it is critical to further explore usage of digital EMAs to capture PA across  
417 populations. This exploration is especially important due to PA's role in minimizing non-  
418 communicable diseases [1,75]. As global PA patterns are consistently reported to educate the  
419 public, and to inform policies to prevent non-communicable diseases [76–81], and as it is  
420 important to accurately capture PA patterns, digital citizen science could play an important role  
421 in ethical surveillance of PA [27].

## 422 **Strengths and Limitations**

423 Strengths of this study include further enhancing our understanding regarding digital tools and  
424 methodologies in reporting health behaviours. It will contribute to new evidence given the  
425 digitization of the surveys themselves, but also because they capture prospective data at  
426 participants' convenience. Such data are collected by researchers in real-time, who can adjust  
427 surveys if needed or send prompts in real-time. In addition, the combination of three validated  
428 surveys to come up with a modified retrospective survey suited for smartphone-based  
429 deployment adds to the strength of this study in this digital age where smartphones have become  
430 ubiquitous. Limitations of this study include subjective surveys within cross-sectional design,  
431 and future research should combine EMA measures with objective data collection using  
432 longitudinal designs.

## 433 **Conclusion**

434 Physical inactivity is the fourth leading cause of mortality globally, and it is critical to  
435 understand patterns of PA using rigorous and validated tools. The findings of this study show  
436 the importance of using prospective EMAs to capture PA, which is particularly relevant in the

437 digital age, where ubiquitous devices provide us with real-time engagement capabilities. More  
438 importantly, digital citizen science can transform how we measure behaviours using citizen-  
439 owned ubiquitous digital tools to support prevention and treatment of non-communicable  
440 diseases.

#### 441 Acknowledgments

442 The authors acknowledge the entire Digital Epidemiology and Population Health Laboratory  
443 team (DEPtH) for their unwavering support. Authors also acknowledge the Canadian Institute  
444 of Health Research for their support to the DEPtH Lab and the Smart Platform.

445

446

447

448

449

450

451

452

453

454

455

456

## 457 References

- 458 1. Saqib ZA, Dai J, Menhas R, et al. Physical Activity is a Medicine for Non-Communicable  
459 Diseases: A Survey Study Regarding the Perception of Physical Activity Impact on Health  
460 Wellbeing. *Risk Manag Healthc Policy*. 2020;13:2949-2962. doi:10.2147/RMHP.S280339
- 461 2. Budreviciute A, Damiati S, Sabir DK, et al. Management and Prevention Strategies for  
462 Non-communicable Diseases (NCDs) and Their Risk Factors. *Front Public Health*.  
463 2020;8:574111. doi:10.3389/fpubh.2020.574111
- 464 3. Kuruvilla A, Mishra S, Ghosh K. Prevalence and risk factors associated with non-  
465 communicable diseases among employees in a university setting: A cross-sectional study.  
466 *Clinical Epidemiology and Global Health*. 2023;21:101282.  
467 doi:10.1016/j.cegh.2023.101282
- 468 4. Booth FW, Roberts CK, Laye MJ. Lack of exercise is a major cause of chronic diseases.  
469 *Compr Physiol*. 2012;2(2):1143-1211. doi:10.1002/cphy.c110025
- 470 5. Matthews CE, Berrigan D, Fischer B, et al. Use of previous-day recalls of physical activity  
471 and sedentary behavior in epidemiologic studies: results from four instruments. *BMC*  
472 *Public Health*. 2019;19(2):478. doi:10.1186/s12889-019-6763-8
- 473 6. Sabia S, van Hees VT, Shipley MJ, et al. Association between questionnaire- and  
474 accelerometer-assessed physical activity: the role of sociodemographic factors. *Am J*  
475 *Epidemiol*. 2014;179(6):781-790. doi:10.1093/aje/kwt330
- 476 7. Sallis JF. Measuring physical activity: practical approaches for program evaluation in  
477 Native American communities. *J Public Health Manag Pract*. 2010;16(5):404-410.  
478 doi:10.1097/PHH.0b013e3181d52804
- 479 8. Shephard RJ. Limits to the measurement of habitual physical activity by questionnaires. *Br*  
480 *J Sports Med*. 2003;37(3):197-206; discussion 206. doi:10.1136/bjism.37.3.197
- 481 9. Marasso D, Lupo C, Collura S, Rainoldi A, Brustio PR. Subjective versus Objective  
482 Measure of Physical Activity: A Systematic Review and Meta-Analysis of the Convergent  
483 Validity of the Physical Activity Questionnaire for Children (PAQ-C). *Int J Environ Res*  
484 *Public Health*. 2021;18(7):3413. doi:10.3390/ijerph18073413
- 485 10. Hallal PC, Victora CG, Azevedo MR, Wells JCK. Adolescent Physical Activity and Health.  
486 *Sports Med*. 2006;36(12):1019-1030. doi:10.2165/00007256-200636120-00003
- 487 11. Medina C, Monge A, Denova-Gutiérrez E, et al. Validity and reliability of the International  
488 Physical Activity Questionnaire (IPAQ) long-form in a subsample of female Mexican  
489 teachers. *Salud Publica Mex*. Published online February 25, 2022:57-65.  
490 doi:10.21149/12889
- 491 12. Bergier J, Kapka-Skrzypczak L, Biliński P, Paprzycki P, Wojtyła A. Physical activity of  
492 Polish adolescents and young adults according to IPAQ: a population based study. *Ann*  
493 *Agric Environ Med*. 2012;19(1):109-115. PMID:22462455



- 494 13. Biernat E, Stupnicki R, Lebedziński B, Janczewska L. Assessment of physical activity by  
495 applying IPAQ questionnaire. *Physical Education and Sport*. 2008;52:46-52.  
496 doi:10.2478/v10030-008-0019-1
- 497 14. Warren JM, Ekelund U, Besson H, et al. Assessment of physical activity - a review of  
498 methodologies with reference to epidemiological research: a report of the exercise  
499 physiology section of the European Association of Cardiovascular Prevention and  
500 Rehabilitation. *Eur J Cardiovasc Prev Rehabil*. 2010;17(2):127-139.  
501 doi:10.1097/HJR.0b013e32832ed875
- 502 15. Roberts-Lewis SF, White CM, Ashworth M, Rose MR. The validity of the International  
503 Physical Activity Questionnaire (IPAQ) for adults with progressive muscle diseases.  
504 *Disability and Rehabilitation*. 2021;0(0):1-9. doi:10.1080/09638288.2021.1983042
- 505 16. Dowd KP, Szeklicki R, Minetto MA, et al. A systematic literature review of reviews on  
506 techniques for physical activity measurement in adults: a DEDIPAC study. *International  
507 Journal of Behavioral Nutrition and Physical Activity*. 2018;15(1):15. doi:10.1186/s12966-  
508 017-0636-2
- 509 17. Zapata-Lamana R, Lalanza JF, Losilla JM, Parrado E, Capdevila L. mHealth technology  
510 for ecological momentary assessment in physical activity research: a systematic review.  
511 *PeerJ*. 2020;8:e8848. doi:10.7717/peerj.8848
- 512 18. Schaller A, Rudolf K, Dejonghe L, Grieben C, Froboese I. Influencing Factors on the  
513 Overestimation of Self-Reported Physical Activity: A Cross-Sectional Analysis of Low  
514 Back Pain Patients and Healthy Controls. *Biomed Res Int*. 2016;2016:1497213.  
515 doi:10.1155/2016/1497213
- 516 19. Skender S, Ose J, Chang-Claude J, et al. Accelerometry and physical activity questionnaires  
517 - a systematic review. *BMC Public Health*. 2016;16:515. doi:10.1186/s12889-016-3172-0
- 518 20. Dishman RK. The measurement conundrum in exercise adherence research. *Med Sci Sports  
519 Exerc*. 1994;26(11):1382-1390. PMID:7837959
- 520 21. Sylvia LG, Bernstein EE, Hubbard JL, Keating L, Anderson EJ. A Practical Guide to  
521 Measuring Physical Activity. *J Acad Nutr Diet*. 2014;114(2):199-208.  
522 doi:10.1016/j.jand.2013.09.018
- 523 22. Tan H, Wilson AM, Lowe J. Measurement of stride parameters using a wearable GPS and  
524 inertial measurement unit. *J Biomech*. 2008;41(7):1398-1406.  
525 doi:10.1016/j.jbiomech.2008.02.021
- 526 23. Prince S, Adamo K, Hamel M, Hardt J, Gorber S, Tremblay M. A Comparison of direct  
527 versus self-report measures for assessing physical activity in adults: a systematic review.  
528 *The international journal of behavioral nutrition and physical activity*. 2008;5:56.  
529 doi:10.1186/1479-5868-5-56
- 530 24. Graham DJ, Hipp JA. Emerging Technologies to Promote and Evaluate Physical Activity:  
531 Cutting-Edge Research and Future Directions. *Front Public Health*. 2014;2.  
532 doi:10.3389/fpubh.2014.00066

- 533 25. Mbunge E, Muchemwa B, Jiyane S, Batani J. Sensors and healthcare 5.0: transformative  
534 shift in virtual care through emerging digital health technologies. *Global Health Journal*.  
535 2021;5(4):169-177. doi:10.1016/j.glohj.2021.11.008
- 536 26. Katapally TR, Chu LM. Digital epidemiological and citizen science methodology to capture  
537 prospective physical activity in free-living conditions: a SMART Platform study. *BMJ*  
538 *Open*. 2020;10(6):e036787. doi:10.1136/bmjopen-2020-036787
- 539 27. Katapally TR, Hammami N, Chu LM. A randomized community trial to advance digital  
540 epidemiological and mHealth citizen scientist compliance: A smart platform study. *PLOS*  
541 *ONE*. 2021;16(11):e0259486. doi:10.1371/journal.pone.0259486
- 542 28. Burke LE, Shiffman S, Music E, et al. Ecological Momentary Assessment in Behavioral  
543 Research: Addressing Technological and Human Participant Challenges. *Journal of*  
544 *Medical Internet Research*. 2017;19(3):e7138. doi:10.2196/jmir.7138
- 545 29. Adams SA, Matthews CE, Ebbeling CB, et al. The effect of social desirability and social  
546 approval on self-reports of physical activity. *Am J Epidemiol*. 2005;161(4):389-398.  
547 doi:10.1093/aje/kwi054
- 548 30. Althubaiti A. Information bias in health research: definition, pitfalls, and adjustment  
549 methods. *J Multidiscip Healthc*. 2016;9:211-217. doi:10.2147/JMDH.S104807
- 550 31. Colombo D, Suso-Ribera C, Fernández-Álvarez J, et al. Affect Recall Bias: Being Resilient  
551 by Distorting Reality. *Cogn Ther Res*. 2020;44(5):906-918. doi:10.1007/s10608-020-  
552 10122-3
- 553 32. Katapally TR, Bhawra J, Leatherdale ST, et al. The SMART Study, a Mobile Health and  
554 Citizen Science Methodological Platform for Active Living Surveillance, Integrated  
555 Knowledge Translation, and Policy Interventions: Longitudinal Study. *JMIR Public Health*  
556 *Surveill*. 2018;4(1):e31. doi:10.2196/publichealth.8953
- 557 33. Katapally TR. Smart Indigenous Youth: The Smart Platform Policy Solution for Systems  
558 Integration to Address Indigenous Youth Mental Health. *JMIR Pediatrics and Parenting*.  
559 2020;3(2):e21155. doi:10.2196/21155
- 560 34. Brodersen K, Hammami N, Katapally TR. Smartphone Use and Mental Health among  
561 Youth: It Is Time to Develop Smartphone-Specific Screen Time Guidelines. *Youth*.  
562 2022;2(1):23-38. doi:10.3390/youth2010003
- 563 35. Craig CL, Marshall AL, Sjöström M, et al. International physical activity questionnaire:  
564 12-country reliability and validity. *Med Sci Sports Exerc*. 2003;35(8):1381-1395.  
565 doi:10.1249/01.MSS.0000078924.61453.FB
- 566 36. Sattler MC, Jaunig J, Tösch C, et al. Current Evidence of Measurement Properties of  
567 Physical Activity Questionnaires for Older Adults: An Updated Systematic Review. *Sports*  
568 *Med*. 2020;50(7):1271-1315. doi:10.1007/s40279-020-01268-x
- 569 37. Wolin KY, Heil DP, Askew S, Matthews CE, Bennett GG. Validation of the International  
570 Physical Activity Questionnaire-Short Among Blacks. *J Phys Act Health*. 2008;5(5):746-  
571 760. doi:10.1123/jpah.5.5.746

- 572 38. Giles-Corti B, Bull F, Christian H, Koohsari MJ, Sugiyama T, Hooper P. Promoting  
573 physical activity—reducing obesity and non-communicable diseases. In: van den Bosch M,  
574 Bird W, van den Bosch M, Bird W, eds. *Oxford Textbook of Nature and Public Health: The*  
575 *Role of Nature in Improving the Health of a Population*. Oxford University Press; 2018:0.  
576 doi:10.1093/med/9780198725916.003.0042
- 577 39. Van Cauwenberg J, Nathan A, Barnett A, Barnett DW, Cerin E, Council on Environment  
578 and Physical Activity (CEPA)-Older Adults Working Group. Relationships Between  
579 Neighbourhood Physical Environmental Attributes and Older Adults' Leisure-Time  
580 Physical Activity: A Systematic Review and Meta-Analysis. *Sports Med*. 2018;48(7):1635-  
581 1660. doi:10.1007/s40279-018-0917-1
- 582 40. Wanner M, Probst-Hensch N, Kriemler S, Meier F, Autenrieth C, Martin BW. Validation  
583 of the long international physical activity questionnaire: Influence of age and language  
584 region. *Prev Med Rep*. 2016;3:250-256. doi:10.1016/j.pmedr.2016.03.003
- 585 41. Hirvensalo M, Magnussen CG, Yang X, et al. Convergent Validity of a Physical Activity  
586 Questionnaire against Objectively Measured Physical Activity in Adults: The  
587 Cardiovascular Risk in Young Finns Study. *APE*. 2017;07(04):457-472.  
588 doi:10.4236/ape.2017.74038
- 589 42. Jefferis BJ, Sartini C, Lee IM, et al. Adherence to physical activity guidelines in older  
590 adults, using objectively measured physical activity in a population-based study. *BMC*  
591 *Public Health*. 2014;14(1):382. doi:10.1186/1471-2458-14-382
- 592 43. Halvorsen R, Palmquist R. The Interpretation of Dummy Variables in Semilogarithmic  
593 Equations. *American Economic Review*. 1980;70(3):474-475. doi:10.1016/0165-  
594 1765(82)90119-7
- 595 44. Rantalainen T, Ridgers ND, Gao Y, Belavý DL, Haapala EA, Finni T. Physical activity  
596 accumulation along the intensity spectrum differs between children and adults. *Eur J Appl*  
597 *Physiol*. 2021;121(9):2563-2571. doi:10.1007/s00421-021-04731-3
- 598 45. Beemer LR, Twardzik E, Colabianchi N, Hasson RE. Patterning of physical activity and  
599 sedentary behavior at and away from school in preadolescent children. *Am J Health Educ*.  
600 2021;52(1):48-55. doi:10.1080/19325037.2020.1853631
- 601 46. Martínez-Alcalá CI, Rosales-Lagarde A, Alonso-Lavernia M de los Á, et al. Digital  
602 Inclusion in Older Adults: A Comparison Between Face-to-Face and Blended Digital  
603 Literacy Workshops. *Frontiers in ICT*. 2018;5. Accessed April 25, 2023.  
604 <https://www.frontiersin.org/articles/10.3389/fict.2018.00021>
- 605 47. Hodge H, Carson D, Carson D, Newman L, Garrett J. Using Internet technologies in rural  
606 communities to access services: The views of older people and service providers. *Journal*  
607 *of Rural Studies*. 2017;54:469-478. doi:10.1016/j.jrurstud.2016.06.016
- 608 48. UNICEF. A Global Framework to Measure Digital Literacy. Published March 19, 2018.  
609 Accessed April 25, 2023. [https://uis.unesco.org/en/blog/global-framework-measure-](https://uis.unesco.org/en/blog/global-framework-measure-digital-literacy)  
610 [digital-literacy](https://uis.unesco.org/en/blog/global-framework-measure-digital-literacy)
- 611 49. Haidar A, Ranjit N, Archer N, Hoelscher DM. Parental and peer social support is associated  
612 with healthier physical activity behaviors in adolescents: a cross-sectional analysis of Texas

- 613 School Physical Activity and Nutrition (TX SPAN) data. *BMC Public Health*.  
614 2019;19(1):640. doi:10.1186/s12889-019-7001-0
- 615 50. Zou Y, Liu S, Guo S, Zhao Q, Cai Y. Peer Support and Exercise Adherence in Adolescents:  
616 The Chain-Mediated Effects of Self-Efficacy and Self-Regulation. *Children (Basel)*.  
617 2023;10(2):401. doi:10.3390/children10020401
- 618 51. McKenzie G, Shields N, Willis C. ‘Finding what works for me’ – a qualitative study of  
619 factors influencing community gym participation for young adults with cerebral palsy.  
620 *Disability and Rehabilitation*. 2022;0(0):1-8. doi:10.1080/09638288.2022.2083243
- 621 52. Rostron ZP, Green RA, Kingsley M, Zacharias A. Associations Between Measures of  
622 Physical Activity and Muscle Size and Strength: A Systematic Review. *Arch Rehabil Res*  
623 *Clin Transl*. 2021;3(2):100124. doi:10.1016/j.arrct.2021.100124
- 624 53. Ito T, Sugiura H, Ito Y, Noritake K, Ochi N. Relationship between the skeletal muscle mass  
625 index and physical activity of Japanese children: A cross-sectional, observational study.  
626 *PLOS ONE*. 2021;16(5):e0251025. doi:10.1371/journal.pone.0251025
- 627 54. Ruedl G, Niedermeier M, Wimmer L, et al. Impact of Parental Education and Physical  
628 Activity on the Long-Term Development of the Physical Fitness of Primary School  
629 Children: An Observational Study. *Int J Environ Res Public Health*. 2021;18(16):8736.  
630 doi:10.3390/ijerph18168736
- 631 55. Muñoz-Galiano IM, Connor JD, Gómez-Ruano MA, Torres-Luque G. Influence of the  
632 parental educational level on physical activity in schoolchildren. Published online 2020.  
633 Accessed April 18, 2023. <https://core.ac.uk/reader/351177380>
- 634 56. Armstrong S, Wong CA, Perrin E, Page S, Sibley L, Skinner A. Association of Physical  
635 Activity With Income, Race/Ethnicity, and Sex Among Adolescents and Young Adults in  
636 the United States. *JAMA Pediatr*. 2018;172(8):732-740.  
637 doi:10.1001/jamapediatrics.2018.1273
- 638 57. Berge JM, Trofholz A, Jacobs N, Tate A. A Mixed-Methods Description of the Home  
639 Physical Activity Environments of Racially/Ethnically Diverse and Immigrant/Refugee  
640 Children. *Global Pediatric Health*. 2022;9:2333794X221133020.  
641 doi:10.1177/2333794X221133020
- 642 58. Katzmarzyk PT. Expanding our understanding of the global impact of physical inactivity.  
643 *The Lancet Global Health*. 2023;11(1):e2-e3. doi:10.1016/S2214-109X(22)00482-X
- 644 59. Milton K, Gomersall SR, Schipperijn J. Let’s get moving: The Global Status Report on  
645 Physical Activity 2022 calls for urgent action. *J Sport Health Sci*. 2023;12(1):5-6.  
646 doi:10.1016/j.jshs.2022.12.006
- 647 60. WHO. WHO highlights high cost of physical inactivity in first-ever global report -  
648 PAHO/WHO | Pan American Health Organization. Published 2022. Accessed April 25,  
649 2023. [https://www.paho.org/en/news/19-10-2022-who-highlights-high-cost-physical-](https://www.paho.org/en/news/19-10-2022-who-highlights-high-cost-physical-inactivity-first-ever-global-report)  
650 [inactivity-first-ever-global-report](https://www.paho.org/en/news/19-10-2022-who-highlights-high-cost-physical-inactivity-first-ever-global-report)
- 651 61. Katapally TR, Bhawra J, Leatherdale ST, et al. The SMART Study, a Mobile Health and  
652 Citizen Science Methodological Platform for Active Living Surveillance, Integrated

- 653 Knowledge Translation, and Policy Interventions: Longitudinal Study. *JMIR Public Health*  
654 *and Surveillance*. 2018;4(1):e8953. doi:10.2196/publichealth.8953
- 655 62. Dunton GF. Ecological Momentary Assessment in Physical Activity Research. *Exerc Sport*  
656 *Sci Rev*. 2017;45(1):48-54. doi:10.1249/JES.0000000000000092
- 657 63. Marszalek J, Morgulec-Adamowicz N, Rutkowska I, Kosmol A. Using Ecological  
658 Momentary Assessment to Evaluate Current Physical Activity. *BioMed research*  
659 *international*. 2014;2014:915172. doi:10.1155/2014/915172
- 660 64. Doherty K, Balaskas A, Doherty G. The Design of Ecological Momentary Assessment  
661 Technologies. *Interacting with Computers*. 2020;32(3):257-278.  
662 doi:10.1093/iwcomp/iwaa019
- 663 65. Folkersma W, Veerman V, Ornée DA, Oldehinkel AJ, Alma MA, Bastiaansen JA. Patients’  
664 experience of an ecological momentary intervention involving self-monitoring and  
665 personalized feedback for depression. *Internet Interv*. 2021;26:100436.  
666 doi:10.1016/j.invent.2021.100436
- 667 66. Palacin V, Ferrario MA, Hsieh G, Knutas A, Wolff A, Porras J. Human values and digital  
668 citizen science interactions. *International Journal of Human-Computer Studies*.  
669 2021;149:102605. doi:10.1016/j.ijhcs.2021.102605
- 670 67. Ram N, Brinberg M, Pincus AL, Conroy DE. The questionable ecological validity of  
671 ecological momentary assessment: Considerations for design and analysis. *Research in*  
672 *Human Development*. 2017;14:253-270. doi:10.1080/15427609.2017.1340052
- 673 68. Stone AA, Shiffman SS. Ecological Validity for Patient Reported Outcomes. In: Steptoe A,  
674 ed. *Handbook of Behavioral Medicine: Methods and Applications*. Springer; 2010:99-112.  
675 doi:10.1007/978-0-387-09488-5\_8
- 676 69. Mitchell RJ, Goggins R, Lystad RP. Synthesis of evidence on the use of ecological  
677 momentary assessments to monitor health outcomes after traumatic injury: rapid systematic  
678 review. *BMC Med Res Methodol*. 2022;22(1):119. doi:10.1186/s12874-022-01586-w
- 679 70. Shiffman S, Stone AA, Hufford MR. Ecological momentary assessment. *Annu Rev Clin*  
680 *Psychol*. 2008;4:1-32. doi:10.1146/annurev.clinpsy.3.022806.091415
- 681 71. Todd KR, Shaw RB, Kramer JLK, Martin Ginis KA. Using ecological momentary  
682 assessment to evaluate neuropathic pain experienced by adults with SCI: recommendations  
683 and participant perceptions. *Disabil Rehabil*. 2021;43(17):2439-2446.  
684 doi:10.1080/09638288.2019.1702724
- 685 72. Price M, van Stolk-Cooke K, Ward HL, et al. Tracking post-trauma psychopathology using  
686 mobile applications: A usability study. *J Technol Behav Sci*. 2017;2(1):41-48.  
687 doi:10.1007/s41347-016-0008-9
- 688 73. Rosenberg S. Smartphone Ownership Is Growing Rapidly Around the World, but Not  
689 Always Equally. Pew Research Center’s Global Attitudes Project. Published February 5,  
690 2019. Accessed April 25, 2023.  
691 [https://www.pewresearch.org/global/2019/02/05/smartphone-ownership-is-growing-](https://www.pewresearch.org/global/2019/02/05/smartphone-ownership-is-growing-rapidly-around-the-world-but-not-always-equally/)  
692 [rapidly-around-the-world-but-not-always-equally/](https://www.pewresearch.org/global/2019/02/05/smartphone-ownership-is-growing-rapidly-around-the-world-but-not-always-equally/)

- 693 74. Ofcom. Children and Parents: Media Use and Attitudes 2023. Published online 2023.  
694 Accessed May 1, 2023.  
695 [https://www.ofcom.org.uk/\\_data/assets/pdf\\_file/0030/255954/annex-1-childrens-media-](https://www.ofcom.org.uk/_data/assets/pdf_file/0030/255954/annex-1-childrens-media-use-and-attitudes-report-2023.pdf)  
696 [use-and-attitudes-report-2023.pdf](https://www.ofcom.org.uk/_data/assets/pdf_file/0030/255954/annex-1-childrens-media-use-and-attitudes-report-2023.pdf)
- 697 75. Santos AC, Willumsen J, Meheus F, Ilbawi A, Bull FC. The cost of inaction on physical  
698 inactivity to public health-care systems: a population-attributable fraction analysis. *The*  
699 *Lancet Global Health*. 2023;11(1):e32-e39. doi:10.1016/S2214-109X(22)00464-8
- 700 76. Pratt M, Ramirez Varela A, Salvo D, Kohl Iii HW, Ding D. Attacking the pandemic of  
701 physical inactivity: what is holding us back? *Br J Sports Med*. 2020;54(13):760-762.  
702 doi:10.1136/bjsports-2019-101392
- 703 77. Kohl HW, Craig CL, Lambert EV, et al. The pandemic of physical inactivity: global action  
704 for public health. *Lancet*. 2012;380(9838):294-305. doi:10.1016/S0140-6736(12)60898-8
- 705 78. Chen S, Kuhn M, Prettner K, Bloom DE. The macroeconomic burden of noncommunicable  
706 diseases in the United States: Estimates and projections. *PLOS ONE*.  
707 2018;13(11):e0206702. doi:10.1371/journal.pone.0206702
- 708 79. WHO E. Promoting physical activity to prevent and control noncommunicable diseases.  
709 World Health Organization - Regional Office for the Eastern Mediterranean. Accessed  
710 April 25, 2023. [http://www.emro.who.int/noncommunicable-](http://www.emro.who.int/noncommunicable-diseases/publications/questions-and-answers-on-promoting-physical-activity-to-prevent-and-control-noncommunicable-diseases.html)  
711 [diseases/publications/questions-and-answers-on-promoting-physical-activity-to-prevent-](http://www.emro.who.int/noncommunicable-diseases/publications/questions-and-answers-on-promoting-physical-activity-to-prevent-and-control-noncommunicable-diseases.html)  
712 [and-control-noncommunicable-diseases.html](http://www.emro.who.int/noncommunicable-diseases/publications/questions-and-answers-on-promoting-physical-activity-to-prevent-and-control-noncommunicable-diseases.html)
- 713 80. Sharma S, Matheson A, Lambrick D, et al. Dietary practices, physical activity and social  
714 determinants of non-communicable diseases in Nepal: A systemic analysis. *PLOS ONE*.  
715 2023;18(2):e0281355. doi:10.1371/journal.pone.0281355
- 716 81. Onagbiye S, Tshwaro R, Andrews B, Young M. Physical Activity and Non-communicable  
717 Disease Risk Factors: Knowledge and Perceptions of Youth in a Low Resourced  
718 Community in the Western Cape. *The Open Public Health Journal*. 2019;12:558-566.  
719 doi:10.2174/1874944501912010558

720

721